

TBM
E-396885.1641
N-3271294.1333

EXISTING
ROAD

TBM
E-396882.3901
N-3271288.0323

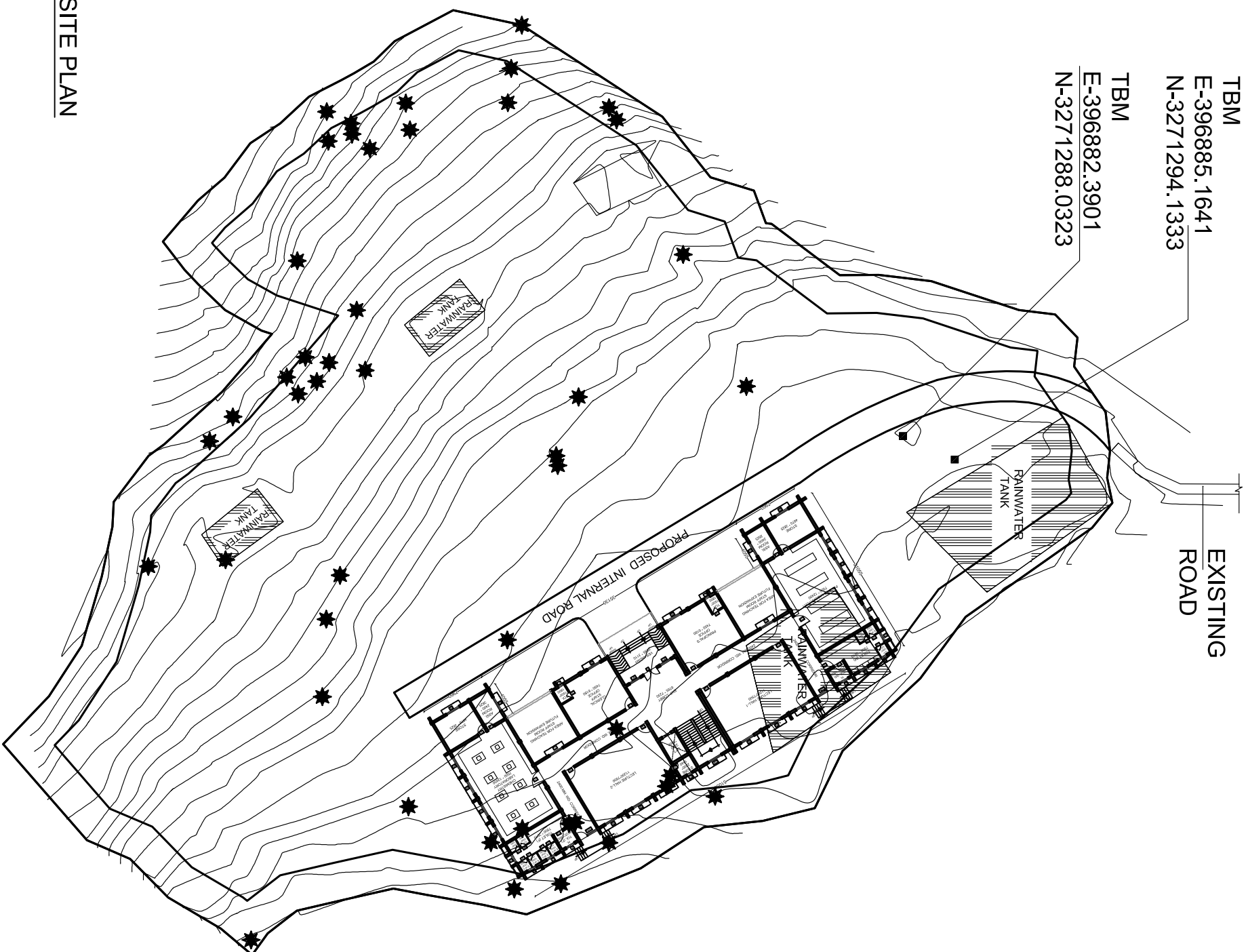

SITE PLAN

AREA STATEMENT:

PLINTH AREA AT GROUND FLOOR	= 853.79 SQ.M.
PLINTH AREA AT GROUND FLOOR (FUTURE EXP.)	= 78.84 SQ.M.
PLINTH AREA AT FIRST FLOOR	= 707.22 SQ.M.
PLINTH AREA AT FIRST FLOOR (FUTURE EXP.)	= 225.18 SQ.M.
PLINTH AREA AT MUMTY	= 58.06 SQ.M.
PLINTH AREA AT SECOND FLOOR (FUTURE EXP.)	= 321.32 SQ.M.
TOTAL PLINTH AREA AT ALL FLOORS	= 1619.07 SQ.M.
TOTAL PLINTH AREA AT ALL FLOORS (FUEXPAN.)	= 2244.41 SQ.M.

DRG. PREPARED BY:

DRG. CHECKED BY:

DRAWING DATE : 31 / 05 / 2022

REVISION DATE :	
REVISION DATE :	
REVISION DATE :	
REVISION DATE :	

PROJECT:

PROPOSED DRAWINGS FOR GOVERNMENT
DEGREE COLLEGE AT DANVA, DISTT. ALMORA
UTTARAKHAND.

SHEET TITLE:

PROPOSED SITE PLAN

SIGN. OF APPROVING AUTHORITY

SIGN. OF J.E.

SIGN. OF A.E.

SIGN. OF P.M.

SIGN. OF ARCHITECT:

SIGN. OF ST. ENGINEER:

CLIENT :-

UTTARAKHAND AGRICULTURAL
PRODUCE MARKETING BOARD

DRAWING NUMBER

1

ARCHITECTS AND ENGINEERS:

NIRMAN CONSULTANTS
F-12, SURYA COMPLEX,
RANIPUR MORE, HARIDWAR,
UTTARAKHAND. 249407
Ph: 9897238034, 9897238025
e mail : ashishkaush@yahoo.com,
rajeevbansal05@gmail.com