

PROJECT:
 PROPOSED DRAWINGS FOR GOVERNMENT
 DEGREE COLLEGE AT DANYA, DISTT. ALMORA
 UTTARAKHAND.

SHEET TITLE:
 PROPOSED GROUND FLOOR PLAN

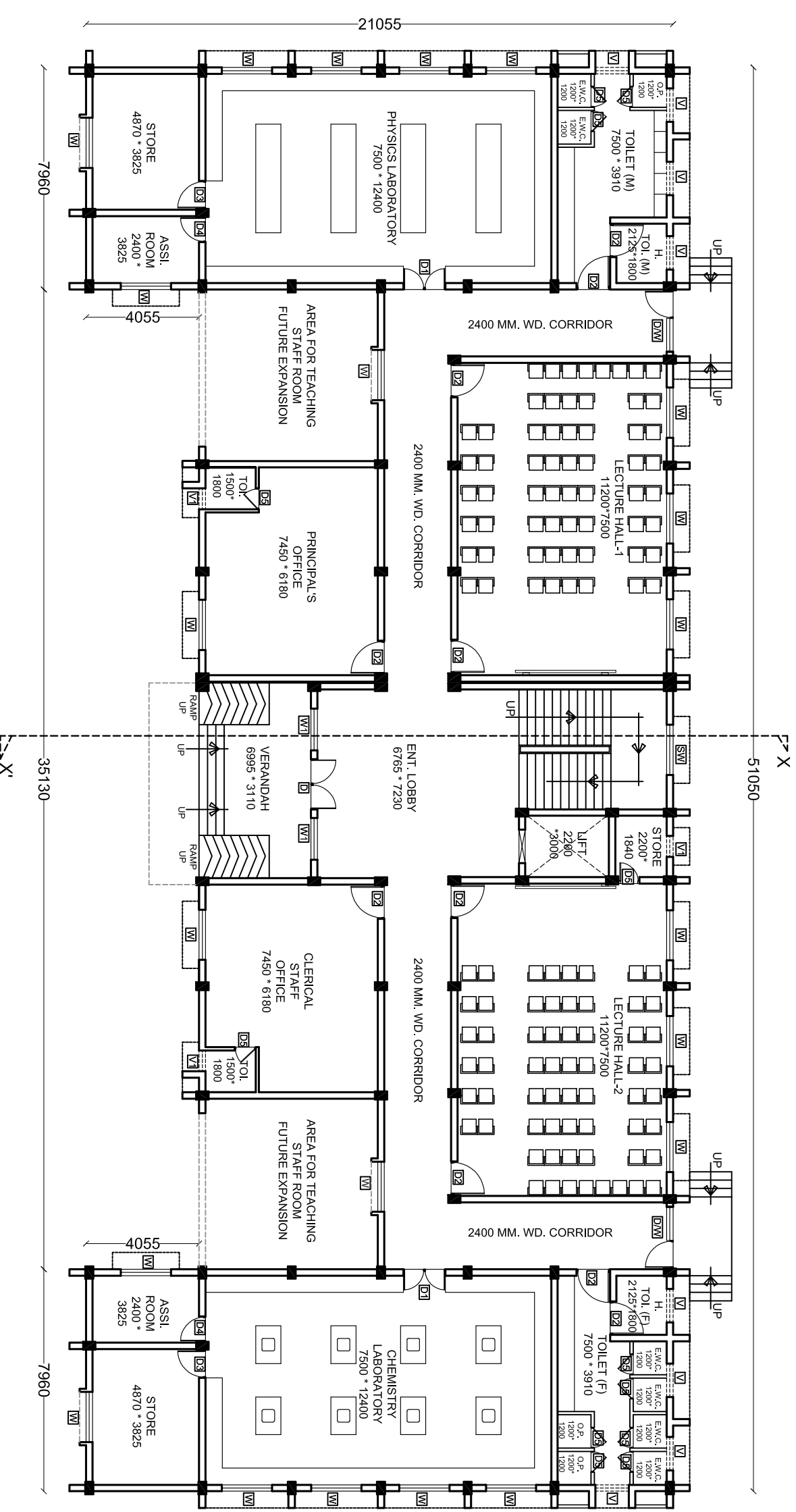

PROPOSED GROUND FLOOR PLAN

CLIENT :-
 UTTARAKHAND AGRICULTURAL
 PRODUCE MARKETING BOARD

DRAWING NUMBER
 ARCHITECTS AND ENGINEERS:
NIRMAN CONSULTANTS

F-12, SURYA COMPLEX,
 RAIPUR MORE, HARIDWAR,
 UTTARAKHAND. 249407
 Ph: 9897238034, 9897238025
 e mail : ashishkaush@yahoo.com,
 rajeevbansal05@gmail.com

DRAWING DATE : 31 / 05 / 2022

REVISION DATE :

REVISION DATE :

REVISION DATE :

REVISION DATE :

REVISION DATE :

REVISION DATE :

AREA STATEMENT:

PLINTH AREA AT GROUND FLOOR = 853.79 SQ.M.
 PLINTH AREA AT GROUND FLOOR (FUTURE EXP.) = 78.84 SQ.M.
PLINTH AREA AT FIRST FLOOR = 707.22 SQ.M.
 PLINTH AREA AT FIRST FLOOR (FUTURE EXP.) = 225.18 SQ.M.
PLINTH AREA AT MUMTY = 58.06 SQ.M.
 PLINTH AREA AT SECOND FLOOR (FUTURE EXP.) = 321.32 SQ.M.
TOTAL PLINTH AREA AT ALL FLOORS = 1619.07 SQ.M.
TOTAL PLINTH AREA AT ALL FLOORS (FUTURE EXPAN.) = 2244.41 SQ.M.

DRG. PREPARED BY:

DRG. CHECKED BY: